



PRO)))SOUND™

Reverso SoundMat

Floor Installation Guide
& Product Overview

Overview

The Reverso SoundMat is a totally unique and specially engineered dual purpose soundproofing mat suitable for both hard or soft floor finishes. A slim and effective floor soundproofing solution designed to reduce unwanted impact and airborne noise, helping you achieve peace and quiet in your home. The built in stabilising layer makes the Reverso SoundMat particularly suited to hard floor final finishes, as the majority of all hard floor finishes can be installed on top. This removes the need of a stabilising layer, which reduces time and costs.



Why Use Reverso Soundmat

- **High performance** - improve the soundproofing capabilities of your floor to achieve peace, quiet and privacy within your own home
- **Straightforward DIY installation** - saving you time and money, without the need of extra labour costs
- **Saves you space** - minimise the build up of floor height with a high performing, slim SoundMat (only 18mm thick)
- **Fast delivery lead times** - 3 - 5 working days

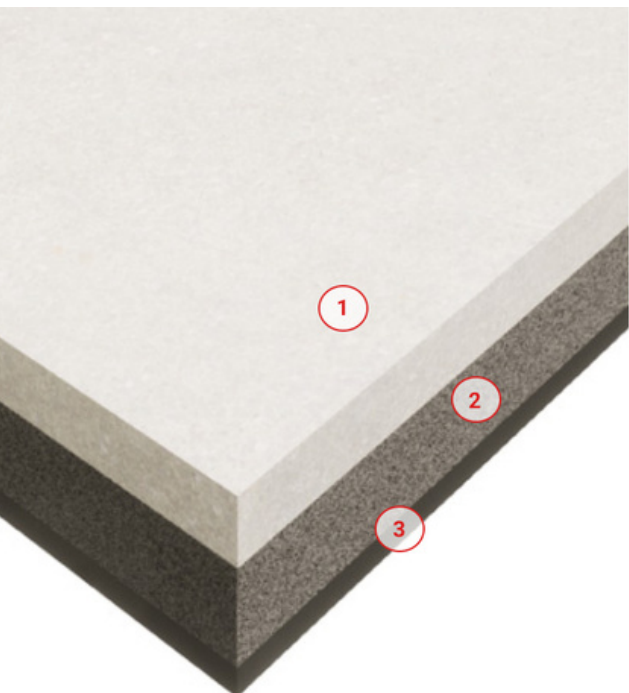

Features

3 layers of Soundproofing materials:

1. 6mm Fibre Cement Board - adds more mass to the floor to help block airborne noise. Whilst also providing a flat stable base for most hard floor final finishes such as, laminate, vinyl, wood and tiles
2. 9mm Closed Cell Foam - dampens sound energy and vibrations (e.g. footsteps)
3. 3mm Mass Loaded Vinyl - a second layer of high mass to further block airborne noise

ProSound Reverso SoundMat Performance

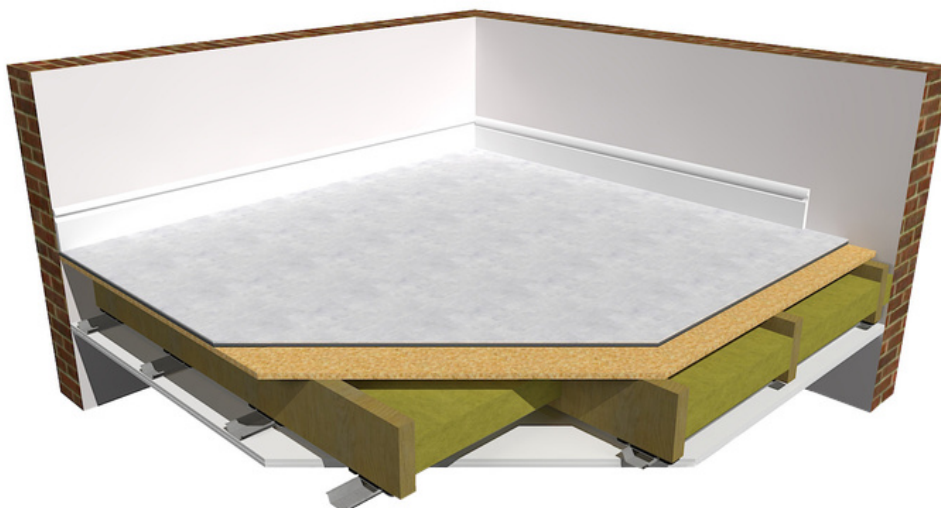

Reverso SoundMat (Performance on timber joisted floor)	Airborne Performance (Higher dB figure the better)	Impact Performance (Lower dB figure the better)
Reverso SoundMat fitted to existing floor (With 100mm mineral wool)	51dB (DnT,w)	51dB (Soft side) 58dB (Hard side) (L'nT,w)
Untreated timber joisted floor performance * (Before Reverso SoundMat)	38dB (DnT,w)	82dB (L'nT,w)

*18mm T&G Chipboard Sub Floor, 200mm floor joists and 12.5mm plasterboard on below ceiling

For more performance data and building regulation compliance please [**CLICK HERE**](#)

Performance Explained

Airborne sound improvement after Reverso SoundMat was fitted	13dB
Impact sound improvement after Reverso SoundMat was fitted	31dB (Soft side) 24dB (Hard side)

For context 10dB improvement is generally perceived by the human ear to being a halving of noise.

For further information on decibels [**CLICK HERE**](#)

Specification

- **Size:** 1200mm x 600mm x 18mm (0.72m²)
- **Weight:** 12.60kg per mat (17.50kg per m²)
- **Water:** Resistant

Thermal Conductivity:

- **6mm Fibre Cement Board:** 0.35 W/mK
- **MLV:** 0.037 W/mK
- **9mm Closed Cell Foam:** 0.039 W/mK

Thermal Resistance:

- **6mm Fibre Cement Board:** 0.17 m² K/W
- **MLV:** 0.095 m² K/W
- **9mm Closed Cell Foam:** 0.23 m² K/W

Fire:

- **6mm Fibre Cement Board:** EN 13501-1: A1
- **MLV:** Surface spread of flame is tested to ISO 3795 and FMVSS 302 - Self Extinguishing
- **9mm Closed Cell Foam:** FMVSS 302

System Components

- High Tack Tape - 33m x 50mm
- Acoustic Sealant - 900ml
- Jumbo Sealant Applicator Gun for 900ml Tubes
- 9mm Gripper Rod Soundproofing Riser - 1.2m (for carpets)
- Perimeter Flanking Strip (25m x 100mm x 5mm)
- Acoustic Mineral Wool
- Plasterboard Scrim Tape - 90m
- Bond-it Tile Adhesive 1.5kg
- 125mm Tile Adhesive Combi Spreader

Please Note: The mats are heavy and we recommend two people for installation

Cutting

The Reverso SoundMat should be cut using a circular saw or jigsaw fitted with a fine toothed blade. This is to ensure a straight cut and smooth finish. A straight edge cutting guide is recommended too.

Installation Instructions

The below installation instructions are for when fitting the Reverso SoundMat to a timber joisted floor or concrete floor with the **hard side up**.

Timber joisted floors: We recommend the use of 60kg Acoustic Mineral Wool underneath the floorboards prior to installing the SoundMat.

1. Ensure the base floor is **smooth, flat and level**. Make sure the floor is free of any dust or debris and seal any gaps between floorboards or holes/cracks in concrete prior to laying the Reverso SoundMats.



2. Add Perimeter Flanking Strip around the perimeter to isolate the Reverso SoundMats from the walls.

3. Lay the Reverso SoundMats in a brick bond pattern butting up to the edging detail.



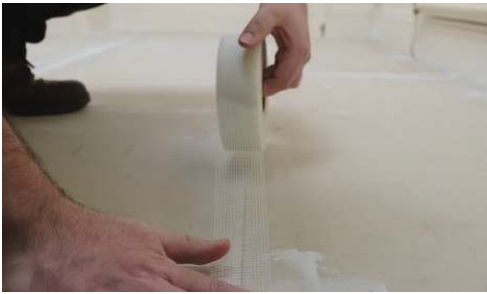

4. Tape over the butt joints with scrim tape to prevent any movement over time.

6. Apply tile adhesive on top of the scrim tape, across all of the joins.

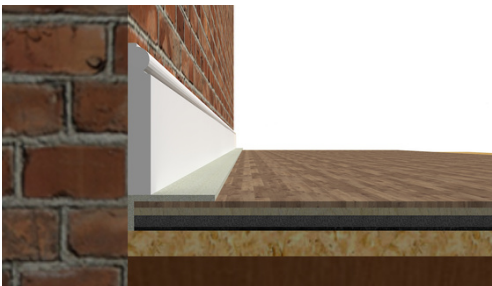

6. Trim off excess perimeter strip or fold over floor layers to place skirting board on top. Install your final floor finish as per the manufacturers instructions

Please note: Do not screw or nail through the Reverso SoundMats

Compatible Floor Finishes For Hard Side

- Laminate
- LVT and Vinyl
- Engineered Wood
- Tiles

Please refer to **Page 9** for more information on hard floor finishes

Installation Instructions

The below installation instructions are for when fitting the Reverso SoundMat to a timber joisted floor or concrete floor with the **soft side up for carpets**.

Timber joisted floors: We recommend the use of 60kg Acoustic Mineral Wool underneath the floorboards prior to installing the Reverso SoundMat.

1. Ensure the base floor is **smooth, flat and level**. Make sure the floor is free of any dust or debris and seal any gaps between floorboards or holes/cracks in concrete prior to laying the Reverso SoundMats.



2. Install the carpet gripper rod risers around the perimeter of the room.

3. Lay the Reverso SoundMats in a brick bond pattern butting up to the edging detail.



ProSound Reverso SoundMat Soft Side Up Installation



4. Tape over the butt joints with high tack tape to prevent any movement over time.

5. Seal around the perimeter and around any pipework with acoustic sealant.

This helps to prevent any airgaps which sound could travel through.

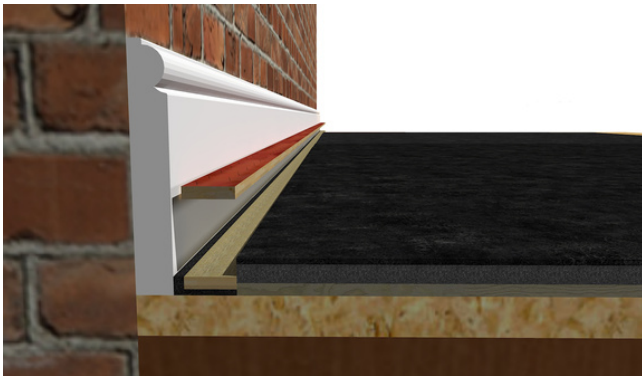

6. Attach gripper rods to the risers and nail through to the subfloor. Install your final floor finish as per the manufacturers instructions

Please note: Do not screw or nail through the Reverso SoundMats

Compatible Floor Finishes For Soft Side

- Carpets

Installation Of Different Floor Finishes

Carpets

- Nail or screw ProSound Gripper Rod Risers around the perimeter of the room (foam edge to be placed up against skirting / wall)
- Install Reverso SoundMats as per installation instructions
- Fix standard carpet gripper rods on top of gripper rod risers for your carpet to be placed on top

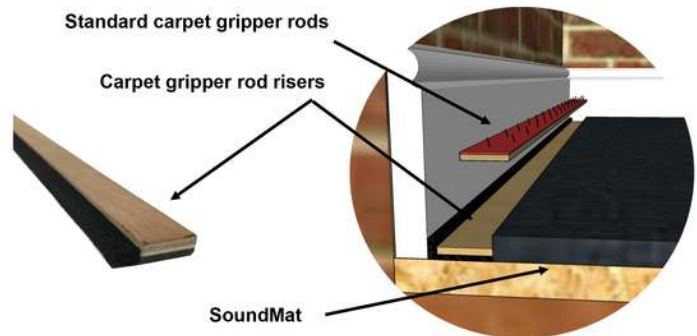

Laminate, Engineered Wood, Tiles* and bonded carpet finishes

- Install ProSound Perimeter Flanking Strip
- Install SoundMats as per installation instructions
- Tape butt joints with Scrim Tape and apply Tile Adhesive over the taped joints
- Install final floor finish (following manufacturers guidelines). Do not mechanically fix
- Trim off excess perimeter strip or fold over floor layers to place skirting board on top

Perimeter Flanking Strip

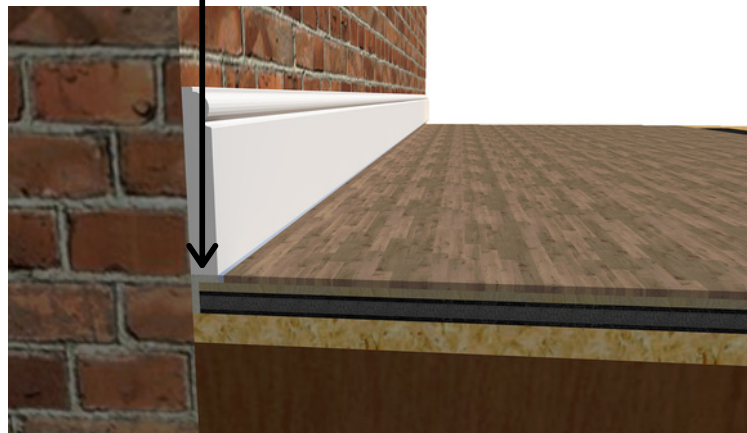

LVT and Vinyls

Follow above instructions for laminate, engineered wood. A self levelling screed or additional overboard may be needed to meet the manufactures guidance. Please speak to the flooring manufacturer prior to installation to check.

Tiles*

For tile adhesive, the board should be primed first and a thicker stabilising board may be needed for some types of tiles. Anti-crack mats can be used if desired.

Underfloor Heating

The Reverso SoundMat is not thermally transparent and underfloor heating must be installed above the mat.

Important Notes

- For installations and applications not listed, please contact The Soundproofing Store for guidance
 - Please ensure Reverso SoundMats are stored flat
 - Reverso SoundMat is a handmade laminated product and has a tolerance of 2-3mm
 - As our products will add weight to your structure, you may wish to check with a structural engineer to ensure compatibility
 - For timber joisted floors we would recommend installing acoustic mineral wool between the floor joists
 - The mass loaded vinyl may emit a small odour when installed or moved. This odour will dissipate in time and we recommend ventilating the room for 24 hours after fitting
 - Hard side up is unprimed and priming may be required prior to using adhesives
 - If you are employing fitters, it's recommended they are booked after materials have been delivered
-

PRO)))SOUND™

Reverso SoundMat

Exclusively available through The Soundproofing Store